

Dates:
 MARCH 17, 2009
 MAY 13, 2009
 OCTOBER 13, 2009
 MAY 3, 2010
 JULY 14, 2010
 OCTOBER 15, 2010
 SEPT 29, 2010
 OCTOBER 18, 2011
 MARCH 15, 2012

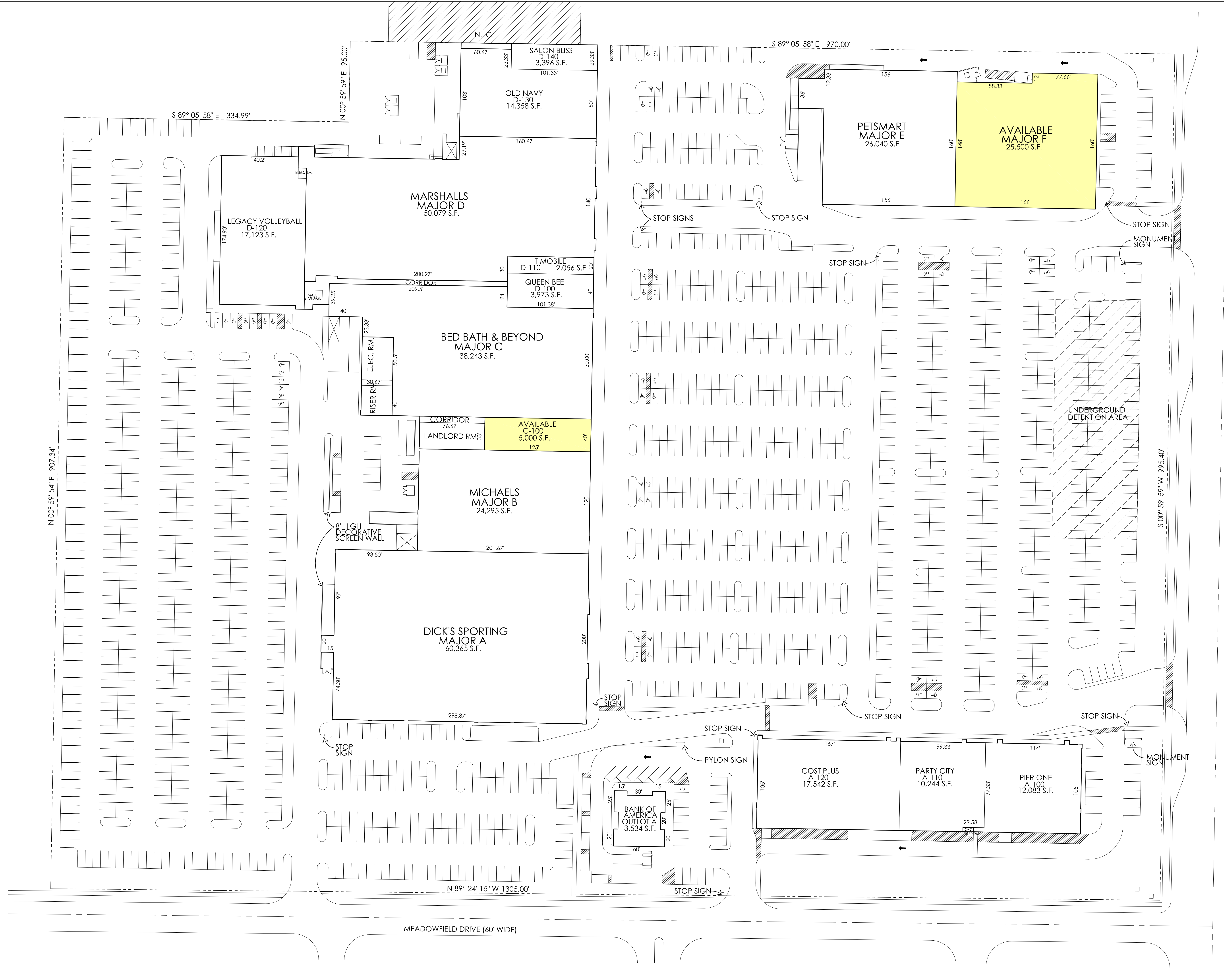

LEASING DATA		
SPACE:	AREA	TENANT:
MAJOR A	60,365 S.F.	DICK'S SPORTING GOODS
MAJOR B	24,295 S.F.	MICHAELS
MAJOR C	38,243 S.F.	BED BATH & BEYOND
MAJOR D	50,079 S.F.	MARSHALLS
MAJOR E	26,040 S.F.	PETSMART
MAJOR F	25,500 S.F.	AVAILABLE
OL-A	3,534 S.F.	BANK OF AMERICA
A-100	12,083 S.F.	PIER ONE
A-110	10,244 S.F.	PARTY CITY
A-120	17,542 S.F.	COST PLUS
C-100	5,000 S.F.	AVAILABLE
D-100	3,973 S.F.	QUEEN BEE
D-110	2,056 S.F.	T MOBILE
D-120	17,123 S.F.	LEGACY VOLLEYBALL
D-130	14,358 S.F.	OLD NAVY
D-140	3,396 S.F.	SALON BLISS
TOTALS		
MAJOR A	60,365 S.F.	
MAJOR B	24,295 S.F.	
MAJOR C	38,243 S.F.	
MAJOR D	50,079 S.F.	
MAJOR E	26,040 S.F.	
MAJOR F	25,500 S.F.	
OL-A	3,534 S.F.	
RETAIL A	39,869 S.F.	
RETAIL C	5,000 S.F.	
RETAIL D	40,096 S.F.	
TOTAL	313,831 S.F.	
TOTAL PARKING	1,915 SPACES	
PARKING RATIO	6.10 / 1,000 S.F.	

LEASE/SITE PLAN
 SCALE: 1" = 50'-0"

AVAILABLE
 LEASED

ROCHESTER ROAD (WIDTH VARIES)

NORTH

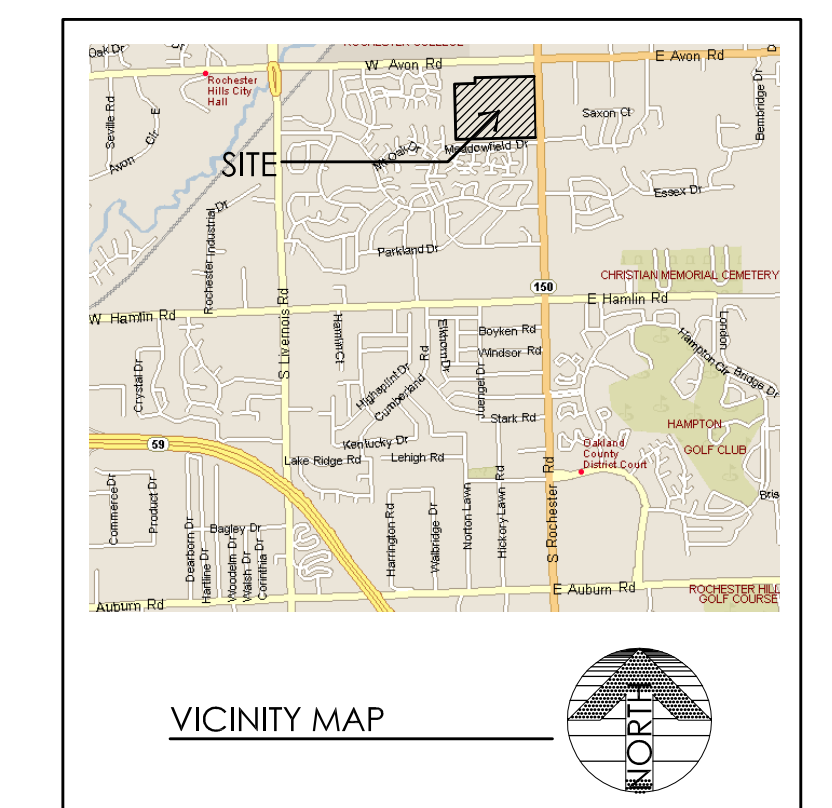

Job Number
3792

Sheet Number
AVAILABILITY-9

Project
WINCHESTER CENTER
 MICHIGAN
 ROCHESTER HILLS, MICHIGAN

Subject
LEASE/SITE PLAN

DISCLAIMER
 THIS DRAWING IS THE PROPERTY OF RAMCO GERSHENSON INCORPORATED. IT IS TO BE USED ONLY FOR THE PROJECT AND SITE SPECIFICALLY IDENTIFIED HEREIN. IT IS NOT TO BE REPRODUCED, COPIED, OR TRANSMITTED IN ANY FORM OR BY ANY MEANS, ELECTRONIC OR MECHANICAL, INCLUDING PHOTOCOPYING, RECORDING, OR BY ANY INFORMATION STORAGE AND RETRIEVAL SYSTEM, WITHOUT THE WRITTEN PERMISSION OF RAMCO GERSHENSON INCORPORATED. THE LAYOUT MAY NOT BE FINAL, NOR IS IT TO BE USED FOR CONSTRUCTION. RAMCO GERSHENSON INCORPORATED IS NOT RESPONSIBLE FOR ANY ERRORS OR OMISSIONS, AND ACCEPTS NO LIABILITY FOR ANY SUCH ERRORS OR OMISSIONS. SEE EXPLANATION OR NOTES FOR FURTHER INFORMATION.

RAMCO GERSHENSON INCORPORATED
 10000 W. ALLEN RD.
 SUITE 100
 TROY, MI 48068
 (313) 486-1000

Do not scale drawings use figured dimensions

CAD DWG AVAILABILITY-9_3-15-12